



WiFi CCT A60 LED
E27 or B22 Globe
21956 21957



Voice
control



**NO HUB
REQUIRED**



works with the
Google Assistant

Works with
IFTTT

USER MANUAL

Box content

Smart CCT A60 LED E27 or B22 x 1
User Manual x 1



Technical Specifications

Model No: 21956 21957

CCT LED: Warm White to Day Light

Working voltage: 220V - 240V AC 50Hz

Power: 9W 49mA

Dimmable: via BrilliantSmart app

Dimension: 112mm x Ø60mm

Base: E27 or B22

Weight: 42g

TA: 0...+35°C

Classification: Class II Construction

Security: Mac Encryption; WEP/WAPI/TKIP/AES

WiFi Standard: IEEE802.11b/g/n

System Req's: iOS 8.0 or higher, Android 4.1 or higher

Installation Guide

IMPORTANT SAFETY ISSUES

Ensure the power is disconnected before installing. This product is NOT suitable for damp or explosive environments.

Modification of this product will void any warranty. Indoor use only.

INSTALLATION

POWER IS TO BE TURNED OFF AT EXISTING WALL SWITCH PRIOR TO INSTALLATION.

Insert smart device into a suitable type light socket/lamp holder by gently pushing then slight twist till globe is locked in position clockwise.

Be sure smart globe is secured in socket/lamp holder.

Turn on smart device via existing wall switch and follow the BrilliantSmart app steps.

Connect to your WiFi

Ensure your mobile phone is connected to your 2.4GHz WiFi network.

Your mobile phone and your smart device needs to be within good signal strength range of your WiFi router. (Refer to your router specifications for max range.)

Download the BrilliantSmart App

Please download the free BrilliantSmart app from the App store or Google Play store, or scan the QR code below.

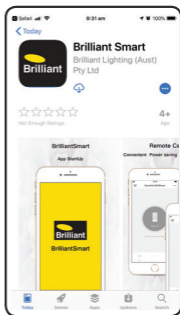

Register the BrilliantSmart App

Open the BrilliantSmart app.

For new users, register a new account or if existing user, login with your user name and password.

Configure your BrilliantSmart App

Setting up your Home

You can setup multiple homes or locations. Click **'Add Home'** button. Or Click on **'Home'** top left if you are adding or modifying details then **'Home Management'** to setup your home(s), add or rename rooms and share devices.

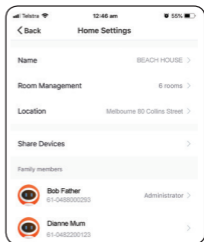

Add your Smart Device to your App

1. On initial power-on, the globe will begin blinking rapidly and be ready to pair. (2 times per second) if smart globe does not start blinking turn OFF/On 3 times or until light starts to blink rapidly)
2. Open the BrilliantSmart App, tap **'Add Device'** (if empty room) or **'+'** to add your Smart Device.

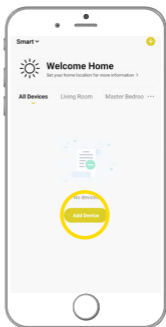

3. The app will Automatically scan for device's and once found will prompt **'Devices to be added: x'**. Select **'Go To Add'**.

4. Select **'+'** to add device.

5. Verify your WiFi Network and Enter your WiFi Network Password. Connection will now Begin.

6. Once connected you will be prompt **'Added successfully'**. Select the room device is located. eg. 'Lounge'. Select the pen icon to change the device name then select done.

7. The Smart Device can now be controlled by the BrilliantSmart App.

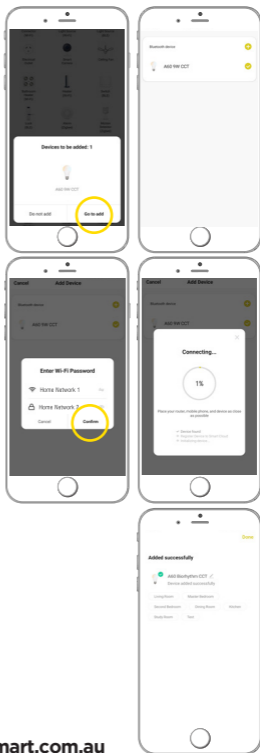

Go to www.brilliantsmart.com.au for full instructions and features.

Warning

1. To prevent injury, this apparatus must be installed Safely and correctly.
2. Do not open or tamper with smart device. Injury may occur.
3. For indoor use only. Not suitable outdoors.
5. Do not allow children to play with wall switch tuning ON/OFF rapidly. This can cause smart device to reset.
6. Power Surge/Power Loss could possibly reset smart device. If this happens follow setup instructions.

NB: BrilliantSmart app screens may differ due to application updates & improvements.

Disposal

Please dispose of this packaging material thoughtfully.

Please dispose of this product thoughtfully once it has passed its useful life.

When your smart device comes to the end of its life or you choose to update or upgrade it, please do not dispose of it with your normal household waste. Please recycle where facilities exist.

When disposing of this fitting, check with your local authority for suitable options.

MADE IN CHINA

Troubleshooting

Problem: Smart device does not switch ON

<i>Possible Cause</i>	<i>Suggested Solution</i>
No Mains Power	Check connections, fuses and switches

Problem: Cannot link smart device with BrilliantSmart app

<i>Possible Cause</i>	<i>Suggested Solution</i>
1. Modem signal weak	Place device and modem closer together
2. Router/modem/smart phone firewall is enabled	Disable firewalls on all devices
3. Internet connection is down	Contact your provider
4. BrilliantSmart app not installed correctly	Remove app and re-install

For any other problems connecting your smart device to BrilliantSmart app please visit:

www.brilliantsmart.com.au/faqs

Brilliant Lighting

956 Stud Road
Rowville Vic 3178 Australia

www.brilliantlighting.com.au

Australian Sales

T 03 9765 2555
T 1800 817 754 (interstate only)
F 03 9763 0277
E sales@brilliantlighting.com.au

New Zealand Sales

T 09 974 9618
E sales@brilliantlighting.co.nz

